

SPM Series

SMT Power Metal Inductor

Size 5030

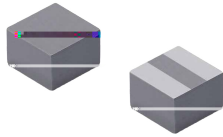

FEATURES

- Large current, Low DC-resistance, High efficiency by magnetic metal powder
- Low acoustic noise and low leakage flux noise by shielded construction
- Halogen Free, 100% Lead(Pb) Free RoHS compliant.
- Operating temperature: -40 °C ~ 125 °C
- Quantity: 1000 pcs/reel

Dimensions: [mm]

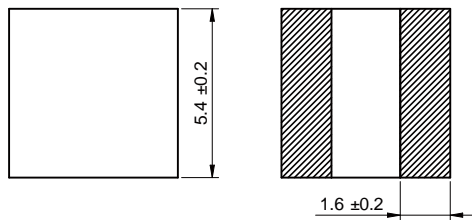

Land Pattern: [mm]

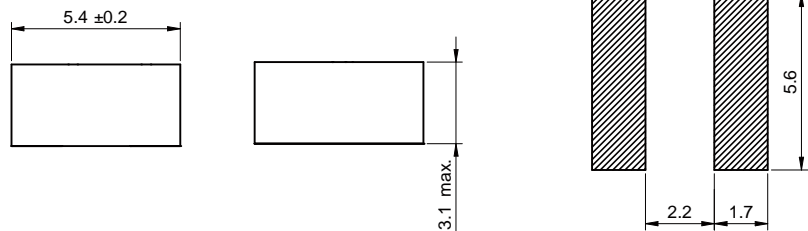

Electrical Properties:

Inductance (μH)	Tolerance	Temperature Rise Current Max. (A)	Saturation Current (A)	DCR Max. (mΩ)	DCR Typ. (mΩ)	Current that causes typical inductance to drop approximately 20%
8.7		7.9	11.5	10.0		
7.0		7.2	15.9	13.8		
5.9		6.0	22.7	19.7		
4.9		4.6	36.9	32.1		
3.9		4.0	67.0	58.2		

Typical Electrical Characteristics:

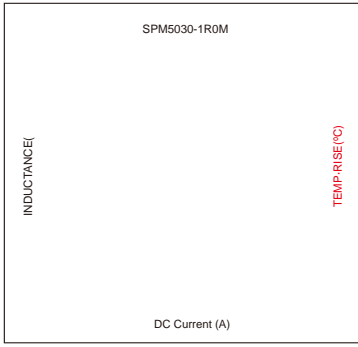

DC Current (A)

